

# State Well Report

## Part 1

Mississippi Department of Environmental Quality  
Office of Land and Water Resources  
P.O. Box 10631  
Jackson, MS 39289-0631  
(601)961-5210  
(601)354-6938 (fax)

For Office Use Only:

Aquifer: \_\_\_\_\_  
Well #: D-88  
L. S. Elevation: \_\_\_\_\_  
E-log #: \_\_\_\_\_

County: Pearl River  
Permit #: \_\_\_\_\_  
Driller: AL HARRINGTON  
Date drilling completed: 9/21/04

State Law requires that this report be prepared by the driller in detail and filed with the Department within 30 days of completion of drilling of the well.

Well Owner Information	Well Location
Owner Name: <u>Marshall Smith</u>	Latitude: <u>N 30° 55' 43.7"</u> Longitude: <u>W 89° 21' 30.1"</u>
Mailing Address: <u>Thomas School Rd</u>	Method of Lat/Long (circle one): Conventional Survey,
<u>Lumberton MS 39455</u>	USGS quad, <u>Hand-held GPS</u> Survey-grade GPS <input checked="" type="checkbox"/>
City State Zip Code	<u>SE 1/4 NE 1/4 Sec 26 Twn 15 Rng 14 W</u>
Telephone No. ( ) _____	Distance Direction Nearest Town
	<u>7 Miles SE of Lumberton</u>

Well Data

Purpose of Well (circle one) Home Industrial Public Supply Irrigation Fish Culture Other: \_\_\_\_\_

Date well drilling started: 9/17/04 Date well drilling completed: 9/21/04

If flowing, method of flow regulation: Valve \_\_\_\_\_ Other (describe) \_\_\_\_\_

Static Water Level: 48' feet above or below (circle one) land surface Date measured: 9/21/04

Method of Measurement (circle one) steel tape electric tape air line other: \_\_\_\_\_

Hole depth: 92' Well depth: 92' Well grouted to a depth of 10' feet

Type of grout (circle one): Cement Bentonite Mix

Casing length: 72' feet Casing diameter: 4" inches Type of casing: PVC

Screen length: 20' feet Screen diameter: 4" inches Type of screen: PVC SAWED

Screen slot size: 1008 inches Setting depth: From 72' feet to 92' feet

Type of completion (circle all applicable): Gravel packed Underreamed Telescoped Open hole Natural Development

Other (describe): \_\_\_\_\_

Top of lap pipe or reduction in casing: \_\_\_\_\_ feet. If telescoped or more than one screen, describe on back of page

Logs run (circle all applicable) No log run Electric Gamma Ray Density Sonic Neutron Other: NCT 21 2004

Name of organization running log(s): \_\_\_\_\_

RECEIVED

OCT 21 2004

BY: OLWR

I certify that the well was drilled, constructed, and completed in accordance with all applicable requirements of the Mississippi Department of Environmental Quality and/or the Mississippi Department of Health regulations and state laws.

AL HARRINGTON #0-564  
Print Name of Water Well Contractor and License No.

AL Harrington  
Signature of Water Well Contractor

If well telescopes please sketch below and show depths.

Ground Level

D 88

Description of Formations Encountered

From To

Description of Formations Encountered	From	To
Red Clay	0	29'
fine red sand	29'	45'
fine to med grain orange white sand.	45'	92'

If more than one screen, show location of each on sketch

Sketch the property layout and include the following: 1) the well location; 2) any permanent structures on the property that may aid in locating the well; 3) any roads, power lines, or other items that may aid in locating the property and the well; 4) indicate direction.

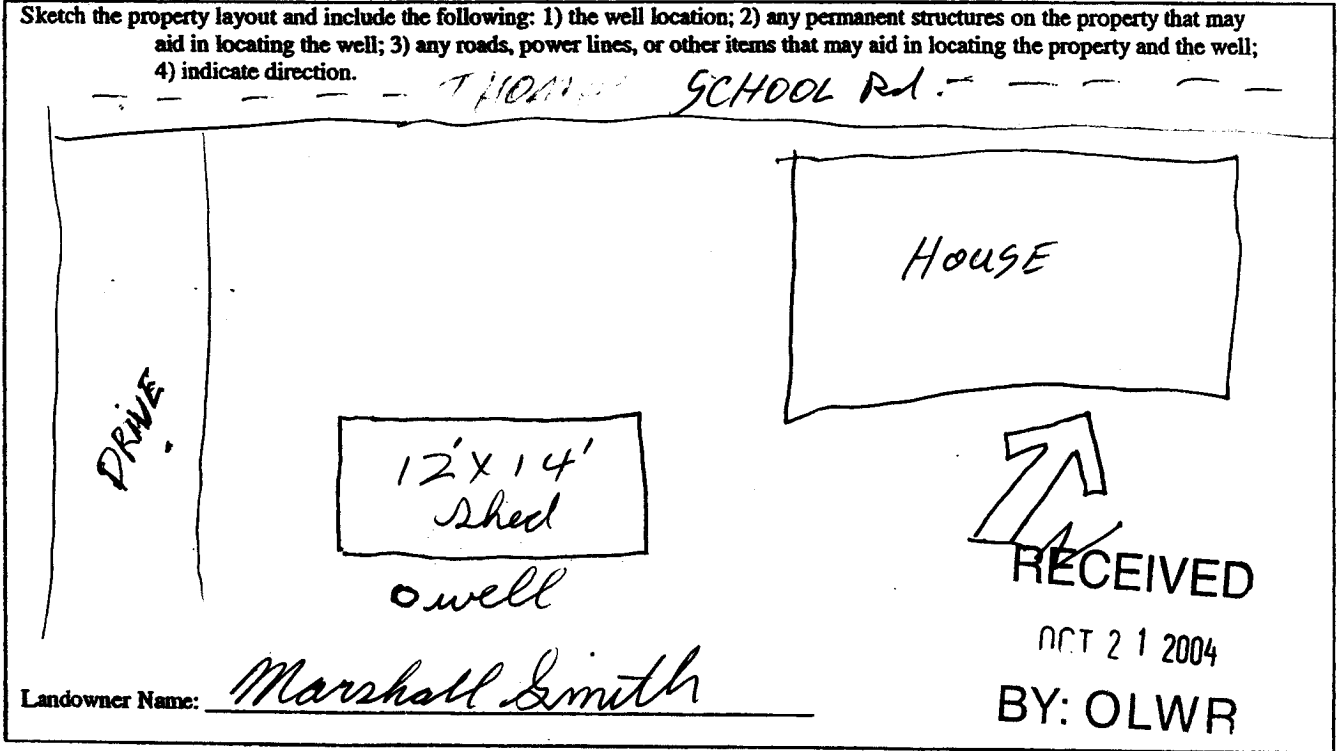

Ol Harrington 0-564  
Signature of Water Well Contractor

# STATE WELL REPORT

## Part 2

**Pump Installer's Completion Report**  
 Mississippi Department of Environmental Quality  
 Office of Land and Water Resources  
 P.O. Box 10631  
 Jackson, MS 39289-0631  
 (601)961-5210  
 (601)354-6938 (fax)

County: Pearl River  
 Permit #: \_\_\_\_\_  
 Driller: AL HARRINGTON  
 Date completed: 9/21/04

**For Office Use Only:**

Aquifer: \_\_\_\_\_  
 Well #: D-88  
 Elevation: \_\_\_\_\_

This report should be prepared by the pump installer in detail and filed with the Department within 30 days of the installation of pump.

Well Owner Information	Well Location
Owner Name: <u>Marshall Smith</u>	Latitude: <u>N 30° 55' 43.7"</u> Longitude: <u>N 89° 21' 30.1"</u>
Mailing Address: <u>Thomas School Rd.</u>	Method of Lat/Long (circle one): Conventional Survey,
<u>Lumberton MS 39455</u>	USGS quad, Hand-held GPS, Survey-grade GPS
City State Zip Code	<u>SE 1/4 NE 1/4 Sec 26 Twn 15 Rng 14W</u>
Telephone No. ( ) _____	Distance Direction Nearest Town
	<u>7</u> Miles <u>SE</u> of <u>Lumberton</u>

Pump Type Circle one	Power Type Circle one
Air Lift Jet <input type="radio"/> <u>Submersible</u>	Diesel Engine Gasoline Engine Natural Gas
Bucket Piston Turbine	<u>Electric Motor</u> Hand Tractor PTO
Centrifugal Rotary Flowing Well	Windmill Other (specify): _____
Other (specify): _____	Horse Power Rating of Motor: <u>2HP</u>
Date Pump Installed: <u>9/21/04</u>	Setting Depth: <u>90'</u> feet
Rated Pump Capacity: <u>28</u> Gallons Per Minute	Number of Stages: <u>28 6PM Pump End.</u>

Pump Test Data	Method of Measuring Water Level Circle one
Date Well Tested: <u>9/21/04</u>	Air Line Electric Measuring Line <u>Steel Tape</u>
Static Water Level (A): <u>48'</u> Feet Below Land Surface	Other (specify): _____
Pumping Water Level (B): _____ Feet Below Land Surface	<b>RECEIVED</b>
Drawdown [(B) - (A)]: _____ Feet Below Land Surface	OCT 21 2004
Test Pumping Rate: _____ Gallons Per Minute	For flowing well, measured shut in head: _____ feet
Duration of Pump Test (minimum 4 hours): _____ hours	Well yielded _____ GPM with a drawdown of _____ feet after _____ hours of pumping

I HEREBY CERTIFY that the above statements are true to the best of my knowledge.

AL HARRINGTON #0-564 Al Harrington 0564  
 Print Name of Pump Installer and License No. (if applicable) Signature of Pump Installer

# topozone

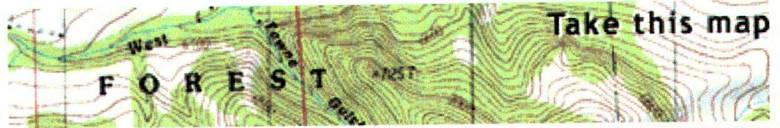

Take this map

- VIEW MAPS
- GET DATA
- MY TOPOZONE
- WEB SERVICES
- ABOUT US

30° 55' 44"N, 89° 21' 30"W (WGS84)  
USGS Carnes Quad

View TopoZone Pro aerial photos, shaded relief, street maps, interact

- Map/Photo Info
- Topo Download
- Photo Download

### USGS Topo Maps

- 1:24K/25K Series
- 1:100K Series
- 1:250K Series

### Map Size

- Small
- Medium
- Large

### View Scale

1 : 50,000

Update Map

### Coordinate Format

D/M/S

### Coordinate Datum

WGS84/NAD83

Show target

[Email this map](#)

[Bookmark this map](#)

[Print this map](#)

myTopo.com

GET A  
CUSTOM  
MAP PRINT

